

---

## WebAccel<sup>(c)</sup> Framework

---



WebAccel is a leading Java/Web application development framework based on a highly flexible and efficient implementation of the standard Model-View-Controller (MVC) architecture. Using WebAccel you can reduce your Java/Web application development time by as much as 80% compared to traditional hand-coding techniques.

The following diagram illustrates all key WebAccel components:

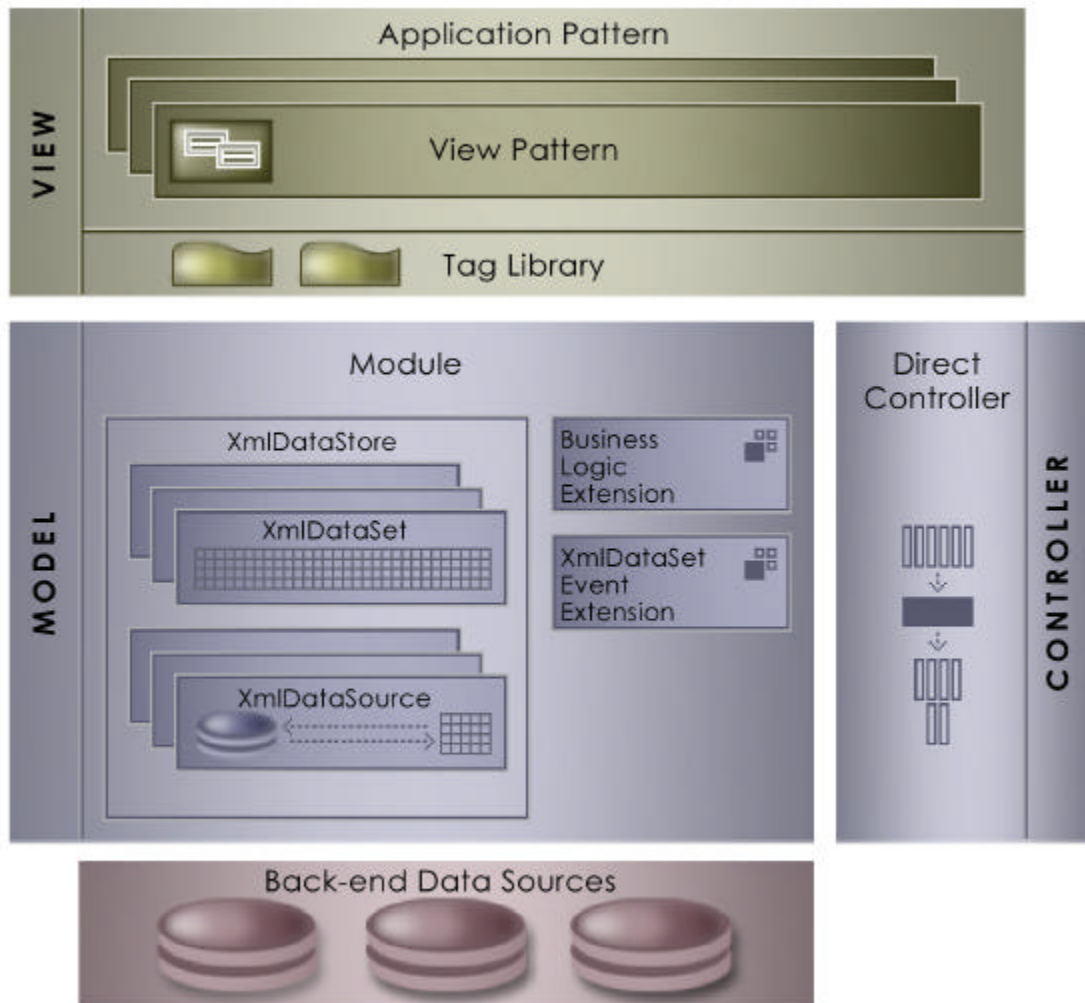

The WebAccel framework is a set of components spanning the entire MVC architecture, from pure Java Model and Controller components that reside and run within the application server, to script-based View components operating in the local user's browser. The WebAccel Tag Library serves as the link between the server and client, and provides a simple, yet powerful platform for business application development.

The main WebAccel components are:

**Application Pattern** Innovative capability of the WebAccel architecture that enables you to create powerful, standardized, thin-client user interface components, and supports rapid application development of complex business applications.

An Application Pattern is composed of one or more View Patterns, each adhering to a particular application style. Each View Pattern provides a unique set of functionality for a user interface window or frameset and functions as a template for standard implementations of the interface design.

View Patterns also automate much of the presentation logic, which greatly reduces the work to build View Pattern Implementations – the individual application windows.

**Module** A dynamic, configurable, virtual business object that supports all data access and business logic requirements. In essence, each Module supports a complete segment of a business application and manages all related record types.

Each WebAccel Module includes an XmlDataStore instance, which in turn contains one or more XmlDataSet objects. Each XmlDataSet provides a logical data buffer for a specific type of business transaction record and communicates with back-end data sources via an associated XmlDataSource. Supported WebAccel data sources include JDBC compliant databases and Web Services.

To perform specialized business processing for the Module, you add your own Business Logic Extension and XmlDataSet Event Extension components as needed.

**Direct Controller** The Direct Controller provides the central WebAccel component responsible for invoking all command scripts sent from the user interface. The engine executes methods in all standard and extension components within the WebAccel application environment.

The advantage of the Direct Controller over traditional URL-based commands is that methods are called using a Java syntax, rather than mapping each URL name to a specific Java class and method. The result: easier-to-read code and a superior link between the client and server components of the environment.

For more information or a complete product demo, contact us at:

Email: [sales@compuflex.com](mailto:sales@compuflex.com)

Phone: (877) 832-6434