

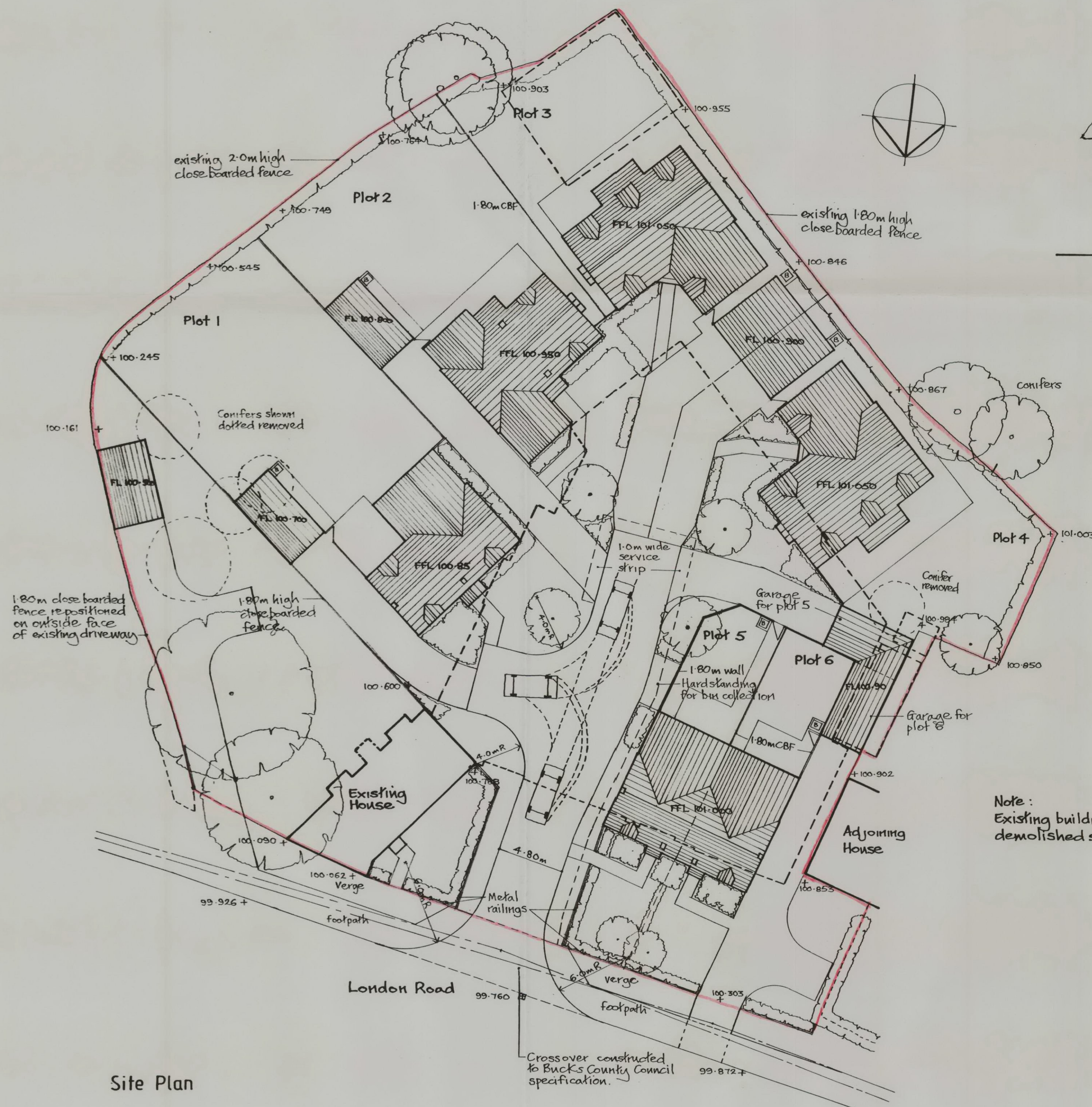

East Side of Private Road Street Scene



London Road Street Scene



Site Plan



Location Plan

Note: Existing buildings to be demolished shown dotted

DEVELOPMENT CONTROL  
- 3 SEP 2010

B LAYOUT AND STREET SCENES AMENDED 08.10.10  
A LAYOUT AMENDED, STREET SCENES ADDED 05.10.10

**Neil Tanner Associates**

Architecture Planning  
Surveying Project Management

The Studio, Old Well House, Turweston, Brackley NN13 5JU  
Tel/Fax: 01280 701081 Email: neiltanner@aol.com

Client: K.G. Madge & Son

Project: Proposed Development  
19 London Road  
Aston Clinton Bucks

Drawing: Site & Location Plans  
Street Scenes

Scale: 1:100, 1:200, 1:250 Drg No: 712-3  
Date: MAY 2010

Drawn: nt

THIS DRAWING IS COPYRIGHT © THIS DRAWING IS NOT TO BE SCALED  
DIMENSIONS TO BE SITE CHECKED BEFORE COMMENCEMENT OF WORK.