

Marine & Offshore Total Solutions



HODU INDUSTRIAL CO.



INDEX

Laboratory System	1
Workshop Equipment	5
Galley & Laundry Equipment	9
Catering Furniture	27
Galley hood & Fire ext. System	29
Medical Equipment	31
Sauna Unit	36
Entertainment & Cinema	38
Gymnasium Equipment	43
Others	47

Laboratory System



HODU IND.'s Laboratory System is the result of many years of creativity and innovation developed by our design staff. We create intelligent furniture solutions and base all our work on the latest ergonomic information. Our products are continually improved, so that we can offer our customers increased safety and comfort at work and we set the standards, especially in the areas of fume cupboard and safety technology.



Auto Protect	
Softmatic	
Digital Air Monitor	
Tailor-made fume cupboards	
Ergonomics	
Exhaust air cleaning	
Extraction control	
Work surface	
Power supply	
Fluid and gas media	
Performance	

Fume cupboard

- Fume cupboards for general use
- High performance fume cupboards
- Radionuclide fume cupboards
- Walk-in fume cupboards
- Distillation fume cupboards
- Pharmaceutical fume cupboards
- Extractors
- Directed extraction and flues

What are the applications for fume cupboards?

Triple protection:
Fume cupboards protect you and your staff from exposure to dangerous substances in the laboratory. They:

1. Retain gases, aerosols and dust effectively
2. Screen against splinters and splatters
3. Prevent accumulation of flammable substances

How can substances be effectively removed?

You can use fume cupboards in the laboratory in a variety of applications. They offer the best possible protection from hazardous substances. Depending on the desired use, you have the choice between the following fume cupboard types:

- Fume cupboards for general use: universal applications
- High performance fume cupboards: for work with particularly aggressive materials
- Distillation and walk-in fume cupboards: for especially large test equipment
- Radionuclide fume cupboards: for work with radioactive isotopes

Pharmaceutical fume cupboards

Pharmaceutical fume cupboards are small fume cupboards, especially designed for use in pharmacies.

Extractor hoods, flues and directed extraction

In addition to fume cupboards and pharmaceutical fume cupboards, **HODU IND.** offers other extraction solutions. These products help you to extract directly from emission sources, remove heat or protect the user when working with very small quantities.



Drawer
organisers



Full draw-out with
cushioning and
automatic retraction



Load capacities



Internal drawers



Magnetic labels



Equipment
pull-out



Lab. Furniture

- Underbench cabinets
- Tall cabinets
- Wall and top mounted cabinets
- Underbench bases
- Free standing tables
- Worktops
- Bowls and sinks
- Furniture accessories

Work space, complete with cabinets and table tops is the core element of any laboratory. Additional sinks or bowls, service points and other accessories transform the individual elements into one complete unit. Whatever your choice is, our laboratory furniture guarantees the highest degree of flexibility and enables you to work efficiently.





Safety Storage

- Safety cabinets for flammable substances
- Gas cylinder cabinets
- Cabinets for acids and bases
- Cabinets for chemicals
- First-Aid cabinets and accessories

Safety is the first priority when working in any laboratory. Laboratory staff deal on a daily basis with numerous dangerous, often hazardous substances.

It is good to know that our range of laboratory furniture includes cabinets for dangerous substances, which reduce their potential to do harm to an absolute minimum. This means that work for you and your staff becomes safer.



If laboratories are to work as efficiently as possible they must have flexible service supplies, which are adaptable for numerous processes. The supply must be flexible and it must be possible to add to it at a later date. In short, service supply in the laboratory must offer the best possible solution for every supply requirement - even if the needs of the user change. **HODU IND.**'s various supply service solutions make sure that you have everything to hand - exactly where you need it.

Service Supply

- Service cells:* visibility in the work place
- Service columns and blocks:* especially flexible with exchangeable cassette system.
- Service walls:* especially for high service demands
- Service booms:* create space on work surfaces
- Service accessories:* for efficient work in the laboratory



Workshop Equipment



Established in 2001, **HODU INDUSTRIAL CO.** are the specialist workshop equipments suppliers to the shipbuilding. With contacts from all over the world, you can be assured of the very best products and technology available when you choose **HODU INDUSTRIAL CO.** as your supplier

Radial Drilling Machine



Specifications	3'H	5'H
Drilling capacity	1-1/4"	2"
Distance from Spindle axis and column	11-13/16 - 39-3/8"	11-3/4 - 63"
Column diameter	9-7/16"	13-3/4"
Spindle taper	4 MT	5 MT
Spindle travel	11"	12.5"
Spindle speeds(number)	16	16
Spindle speeds(range)	32 - 2500	25 - 2000
Spindle feeds(number)	8	16
Spindle feeds (IPR)	.004"-.05"	.0015"-.125"
Horizontal traverse of spindle head	27-9/16"	50"
Arm elevating motor	1 HP	2 HP
Coolant pump motor	0.1 HP	0.12 HP
Spindle motor	2 HP	5.5 HP
Overall dimensions (L x W x H)	70"x43"x81"	98.5"x42"x105"
Weight	3,500 lbs.	7,700 lbs.

Lathe



Specifications	20-4 Series	24-4 Series
Swing over bed	20 1/4"	25"
Swing over cross slide	11 7/8"	17"
Swing over gap	27 5/8"	33"
Length of gap	15"	
Length of gap (in front of faceplate)	8 3/8"	
Workpiece Weights		
At headstock	1,000 lbs.	
Between centers	4,000 lbs.	
Between centers (w/ steady rest)	5,000 lbs.	
Headstock		
Spindle speeds (number) range	(15) 11.5-1400 RPM	(21) 20-1250 RPM
Hole thru spindle	4 1/8"	
Main Motor	10 HP	15 HP
Coolant Pump	1/4 HP	
Bed Lengths & Weights	60" - 6,800 lbs.	60" - 7,000 lbs.
	80" - 7,200 lbs.	80" - 7,400 lbs.
	120" - 7,800 lbs.	120" - 8,000 lbs.
	160" - 8,500 lbs.	160" - 8,700 lbs.

Milling Machine



Specifications	V - 242B	VS - 350B	VS - 550B
Motor size (2 speeds)	2 HP	3 HP	5 HP
Spindle Speeds - number	16	Inf. variable	Inf. variable
Spindle speeds - range	80-5440 RPM	60-4200 RPM	80-3500 RPM
Spindle taper	R-8	R-8	40 taper
Spindle Travel	5"	5"	5.5"
Spindle feed range	.0015/.003/.006 ipr	.0015/.003/.006 ipr	.0015/.003/.006 ipr
Head movement(side to side)	+/- 90°	+/- 90°	+/- 90°
Head Movement(front to back)	+/- 45°	+/- 45°	n/a
Table size (WxLxH)	9"x42"x3 -1/8"	10"x50"x3 -1/8"	11"x52"x3 -1/8"
Table feed (longitudinal)	30"	36"	32"
Table feed (cross)	16"	16"	16"
Max weight of work piece	850 lbs.	850 lbs.	990 lbs.
Rotation of over arm	360°	360°	360°
Over arm adjustment	17 1/4"	22"	24"
Spindle nose to table	2-1/2" - 18-1/2"	2-1/2" - 18-1/2"	2" - 22"
Weight	2200 lbs.	2900 lbs.	3740 lbs.

Arc & Tig Welder



Technical Specifications

Product Name	Product Number	Input Power	Rated Output Current/Voltage/Duty Cycle	Input Current@ Rated Output	Output Range	Dimensions H×W×D in.(mm)	Net Weight lbs.(kg)
DC-400	K1308-11 K1308-12	230/460/3/60	400A/36V/100% (450A/38V/60%) (500A/40V/50%)	78/39A	60-500A 12/42V	27.5×22.3×33.1 (698×566×840)	473 (215)
	K1309-20 K1309-21	220/380/440/ 3/50/60		81/47/40A			

Mig Welder



Specifications



Rated Output	Net Weight	Net Weight	Net Weight	Amps Input at 230V	Rated Output 380V	Rated Output 440V	Rated Output 460V	Rated Output 50/80Hz 460V	Rated Output 575V	KVA	KW	Dimensions	Net Weight
650 A at 44VDC, 100% Duty Cycle	10-44V	15-44V	54VDC	96	58	54	50	48	38	38.2	34.2	H:30 in(762mm) including lift eye W:23 in(585mm) D:38 in(966mm) including strain relief	472lb (214kg)

Air Plasma Cutting & Gouging



Technical Specifications



Rated Output	Max. Open-Circuit Voltage	Amps Input at 208V	Rated Output 230V	Rated Output 380V	Rated Output 400V	Rated Output 415V	Rated Output 460V	Rated Output 575V	KVA	KW	Plasma Gas	Dimensions	Weight with Torch
55A at 110VDC, 60% duty cycle, 3-Phase	280VDC	21	20	10	10	10	9	8	7.6	7.4	Air of Nitrogen only	H:17in(432mm) W:12-1/2in(318mm) D:20-3/4in(527mm)	Net: 86lb (39kg)
55A at 110VDC, 50% duty cycle, 1-Phase		36	33	-	-	-	16	13	7.5	7.4			Shop: 93.5lb (42.4kg)

Welding Rod Oven



Distribution system for welding gases

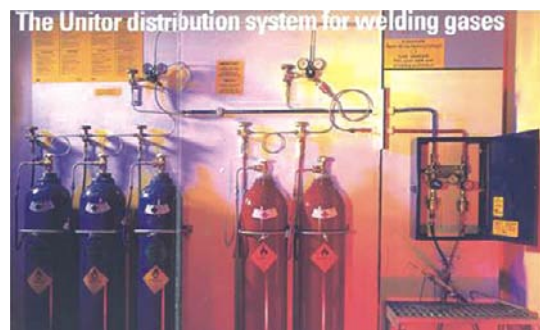



Hydraulic Press

- * *H-Frame*
capacity : 10 - 200 tons
max. daylight & width : 54.5 - 48.0 inch
max. pressure : 10,000 psi
- * *Abor Press (5 / 10 / 20 tons)*
- * *Cylinders / Pumps*
- * *Hoses / Couplers / Valves etc.*

Drilling Machine



Cold Metal Saw



Grinding Machine



Galley Equipment



Established in 2001, **HODU INDUSTRIAL CO.** are the specialist galley equipment suppliers to the shipbuilding. With contacts from all over the world, you can be assured of the very best products and technology available

when you choose **HODU INDUSTRIAL CO.** as your supplier

This galley equipment offers adequate counter space for food preparation to the left of the range and near the sink. Simple lines in the cabinetry keep the small room from feeling visually cluttered.

Electric cooking range



- Attractive appearance and advanced styling
- Stainless steel construction
- Tubular stainless steel leg with 1 hole flanged adjustable feet for deck mounting
- Panel can be opened at the front, service and inspection of components is easy
- Easy to clean
- Removable and adjustable storm rail for safety
- Top section consists of 4 (300mm x 300mm)plates or 6 plates
- Plates with 6 position controls.
- Blocked stainless spillage tray
- High quality electrical elements installed
- Good figure of hot plate cable's array
- Lower part(shelf) is easily compatible with baking oven

Hodu	Dimensions(mm)	Electric Date
ECR-160	900x850x900	440V 60Hz 3Ph/16kW
ECR-165	900x850x900	440V 60Hz 3Ph/21kW
ECR-240	1220x850x900	440V 60Hz 3Ph/24kW
ECR-245	1220x850x900	440V 60Hz 3Ph/29kW

Electric tilting kettle

- Stainless steel construction
- Panel can be opened at the front, service and inspection of components is easy
- Rounded surface for easy cleaning
- Available for multiple uses(Cooking, Stewing, Boiling and Braising)
- Pressure gauge, safety valve and pressure protector
- Tight closing lid without leakage
- Triple skinned kettle for user's safety
- Integral steam generator
- Manual hand wheel tilting system
- Electric power can be loaded step by step by power regulator
- Equipped water level sensor for steam generator
- Polygon type bowl will be change to cylinder type bowl



Hodu	Dimensions(mm)	Electric Date/Capa(Ltr)
ETK401	1070x580x900	440V 60Hz 3Ph / 9kW / 40ℓ
ETK402	1950x580x900	440V 60Hz 3Ph / 18kW / 80ℓ

Electric baking oven



- Stainless steel construction
- Tubular stainless steel legs with 1 hole flanged adjustable feet for deck mounting
- Panel can be opened at the front, service and inspection of components is easy
- Two heaters controlled separately in each chamber
- Back up thermostat is adopted to prevent overheat
- Even spread heat
- Double-glazed door allows good visibility to all part of the oven
- Cleaning is easy due to detachable rails and a mirror-polished, round-cornered chamber
- The chamber is suitable to fit 2 G/N 1/1 pans
- Over flow tray can be pulled out for cleaning
- The rear side fume damper is controlled at the front panel
- The appliance can be arranged with stand or 3 tiered shelf type

Hodu	Dimensions(mm)	Electric Date
EBO-050	895x845x1175	440V 60Hz 3Ph / 5kW
EBO-051	895x845x1175	440V 60Hz 3Ph / 6kW
EBO-550	895x845x1675	440V 60Hz 3Ph / 10kW
EBO-551	895x845x1675	440V 60Hz 3Ph / 11kW
EBO-555	895x845x1675	440V 60Hz 3Ph / 15kW

Electric tilting frying pan

- Stainless steel construction
- Panel can be opened at the front, service and inspection of components is easy
- 8mm thick stainless steel panel with air pocket underneath
- Thermostat(controlled within 50 °C~300 °C) and load is regulated by 3 heat switches(off, low, mid, high)
- Tilting fan has inner rounded corners for easy cleaning
- Manual hand wheel tilting system
- Back up thermostat is adopted to prevent overheat



Hodu	Dimensions(mm)	Electric Date
EFP27	1055x470x900	440V 60Hz 3Ph / 6kW



Electric deep fat fryer

- Stainless steel construction
- Tubular stainless steel legs with 1 hole flanged adjustable feet for deck mounting
- Panel can be opened at the front and rear, service and inspection of components is easy
- Control knob, switch and signal lights on front panel
- Oil saving slow warming period
- Drain tank and filter in the cupboard
- Very high insulation resistance against heating element(Lamp type)
- No need to lift of heating elements and easy cleaning frying tank inside
- Notify fry finishing time and cut off electric power to heating element
- Acquired a patent for an Fryer using NIR lamp (Near- Infrared Ray lamp)
- **Patent Number. 10-1013267**

Hodu	Dimensions(mm)	Electric Date
HEF70	350x700x900	440V 60Hz 3Ph / 7kW
HEF140	580x700x900	440V 60Hz 3Ph / 14kW

Electric griddle

- Stainless steel construction
- Tubular stainless steel legs with 1 hole flanged adjustable feet for deck mounting
- Panel can be opened at the front, service and inspection of components is easy
- 8mm thick stainless steel plate with air pocket indemeath
- Griddle has a thermostat cycling light and electric element for maximum temperature control and energy savings
- Rare and side splash guard sloped towards front
- Temperature controlled by a thermostat 30°C~350°C and load is regulated by 3 heat switch(low, mid, high)
- Locker with hinged door
- Drawer-type fat basin under the griddle
- Back up thermostat is adopted to prevent overheat



Hodu	Dimensions(mm)	Electric Date
HEG45	350x650x880	440V 60Hz 3Ph / 4.5kW

Electric bain marie



- Stainless steel construction
- Tubular stainless steel legs with 1 hole flanged adjustable feet for deck mounting
- Panel can be opened at the front, service and inspection of components is easy
- The temperature is controlled by thermostat within 0°C~90°C
- The grooved rail on the top plate is adopted for easy handling G/N pans
- The top plate with marie edge is easy to keep clean the mess room floor from the food particles

Hodu	Dimensions(mm)	Electric Date
EBM212	840x700x900	220V 60Hz 1Ph / 1.2kW
EBM317	1200x700x900	220V 60Hz 1Ph / 1.7kW
EBM422	1560x700x900	220V 60Hz 1Ph / 2.2kW

Electric hot plate



- 1000W power
- Cast-iron flat heating plate
- Stainless steel top
- easy to clean
- adjustable temperature knob
- anti roll back

Hodu	Dimensions(mm)	Electric Date
HP-1B	297x265x87	220V 60Hz 1Ph / 4.5A

Electric rice cooker



- Big capacity
- Manual type (Cook, Warm)
- Fluor plastic teflon coating inner pot
- High stainless lid
- One touch button control
- Double safety device (Thermostat, Overheat thermostat)

Hodu	Dimensions(mm)	Electric Date
LJ-MB282	472x410x470	220V 60Hz 1Ph / 1.5kW / 28PER

Electric toaster

- The toaster combines simplicity and sophistication perfectly
- With extra wide 28mm slots to accommodate a sandwich and the pre heat elements, a patented design which increases toasting efficiency & element longevity
- Manually operated the toaster features switches to control the degree of browning and an ejector system which means that the toast does not pop up but stays warm until the ejector lever is pushed up
- Removable lid for slots is supplied together



Hodu	Dimensions(mm)	Electric Date
BH-003	380x130x165	220V 60Hz 1Ph / 1.3kW

Electric meat slice



- Slice meat, cheese and vegetables for your deli with the heavy-duty-premium slice from turbo air
- High-quality knife blade stays sharp, resists corrosion and makes precise, uniform cuts
- Permanently attached knife ring guard and interlock knife cover keep hands safe and stainless steel receiving plate and food contact zone provide easy to clean surfaces

Hodu	Dimensions(mm)	Electric Date
MS220	560x520x500	220V 60Hz 1Ph / 0.4kW

Electric micro wave oven

- Heating protection : two way heating
- Cooking : one touch auto cooking
- heat : manual heat
- Thaw : general thaw, speed thaw
- Wisdom for living : door lock(safety device)
forget prevention function
power saving
deodorize
sterilize(dish towel)
steam towel



Hodu	Dimensions(mm)	Electric Date
MM-M301	530x380x312	220V 60Hz 1Ph / 1.45kW

Coffee machine



- With the coffee brewer M series you can easily and quickly brew fresh coffee directly into a glass jug. The brewing time is about 6minutes for 15 cups. The self regulating hot plates ensure that the coffee is always at the correct temperature
- The coffee brewer is equipped with a water connection. The easy soft keys on the upper side of the coffee brewer provide for optimal user convenience
- The coffee brewer equipped with a jug detector which starts and stops the brewing proces. The basket filter has a leak stop, which prevents further dripping
- Fixed water connection 3/4"
- Leak stop
- Acoustic signal which indicates when the coffee is ready
- Descale indicator
- Dry boil safety guard

Hodu	Dimensions(mm)	Electric Date
M100	205x420x540~650	220~240V 50~60Hz 1Ph / 2.25kW
B200	215x370x500~600	220~240V 50~60Hz 1Ph / 2.8kW

Electric water boiler

- Construction from stainless steel
- Comes with two insulated side handles for safe, secure handling and lifting
- Insulated faucet handle
- Temperature control
- On/off indicator
- Comes with sight tube / water level indicator



Hodu	Dimensions(mm)	Electric Date
U10	φ250x380	220~240V 50~60Hz 1Ph / 3kW

Dough mixer



- Designed especially for heavy dough environments typically found in pizza, bagel, bakery and cake/pie operations
- High grade cast iron structure is solid and stable and is also a convenient height for adding or removing material from the bowl
- Designed to stop if the front safety guard is raised, this guard also allows operators to easily add ingredients or view the mixing process without risk

Hodu	Dimensions(mm)	Electric Date
HS30D	530x910x1100	440V 60Hz 3Ph / 1.72kW

SPAR Universal mixer

- High efficiency SPAR mixer offer convenient trouble free operation during demanding work conditions in any establishment
- Interlocked safety guard
- Automatic stop and power off when bowl is lowered
- Available in three or single phase with locking emergency stop button, timer and motor cooling system
- Noiseless operation simple maintenance and high torsion motors contain hardened alloy gears, a 3-speed transmission with all gears 25% larger than usual to ensure greater strength
- All machines are coated with long lasting enamel which is easy to clean and which is toxin free



Hodu	Dimensions(mm)	Electric Date
SP-200	470x540x850	220V 50~60Hz 1Ph / 1/2HP

Electric potato peeler



- Made of ANSI 304 stainless steel
- Self tensioning poli-v belt drive
- High efficiency ventilated motors for continuous operation
- Stainless steel peeling disc
- Easy to replace abrasive surface
- Patented removable dishwashing safe container and bottom peeling disc (no tools required)
- Automatic unloading system
- Stainless steel outlet opening with quick and sealed locking
- Adjustable S/st feet can be fixed to the floor
- Easy service and easy access to the components
- Ingress protection code : IP33

Hodu	Dimensions(mm)	Electric Date
PPJ10SC	470x544x910	220V 50~60Hz 1Ph / 735W

Waste disposer 500 Excellent series

• The 500 excellent series has been designed to meet modern demands for the handling of food waste wherever it is produced in the kitchen. The grinding unit of special cast steel alloys and its unique shaft seals, together with IP55 classified motors ensure that the disposer give long and trouble free service. The choice of the basic model depends upon the type and volume of food waste to be ground. The diperator 500 excellent series has DNV approval for compliance with IMO MARPOL 73/78 ANNEX V for disposal of ground food waste into the open sea



Hodu	Dimensions(mm)	Electric Date
510BS	2"BPS, Female	440V 60Hz 3Ph / 0.75kW
515BS	2"BPS, Female	440V 60Hz 3Ph / 1.1kW
520BS	2"BPS, Female	440V 60Hz 3Ph / 1.5kW

Waste disposer



- Designed to meet modern demands for handling food waste in small commercial kitchens and galleys
- Disposer complies with MARPOL regulations
- No welding is required for installing model 275 into existing sink unit. A screw joint attachment is fitted into a 90mm drain hole in the bottom of the sink onto which the disposer is connected

Hodu	Dimensions(mm)	Electric Date
275	φ210x320	220~240V 50~60Hz 1Ph / 600W

Waste disposer

- Perfect choice for kitchens and galleys where small amounts of food waste should be disposed of continuously while work is in progress
- Designed to be installed as a separate unit, this disposer is delivered ready to connected to existing flushing water, drainage and electrical supplies. The positioning of the waste water outlet can be adjusted when installing to suit the position of the existing drain
- Opening into the grinding chamber allows continuous feeding of good waste into the disposer without hazard to the operator
- The disposer grinds waste to a particle size that complies to MARPOL regulations for discharging good waste at sea
- Flushing water control automatic solenoid valve operating in conjunction with motor. Flushing nozzles in ready assembled pipe



Hodu	Dimensions(mm)	Electric Date
275-MC	500x500x855	220V 50~60Hz 1Ph / 600W

Dish washer



- Body and boiler made in ANSI 304 stainless steel
- 36 fixed washing jets (18 top and 18 bottom) with internal sprinkler non-stop complete water coverage
- 16 rinsing jets : 8 fixed at the top and 8 at the bottom(4 fixed and 4 revolving)
- Includes two 50x50 cm baskets, one for glasses and cups and one for 18 dishes up to 28 cm. φ. And one cutlery basket

Characteristics

1. Automatic operation with adjustable timer
2. Automatic filling of water
3. Partial renewal of washing water during rinse cycle
4. Temperature regulation for washing and rinsing with two separate thermostats
5. Hot water rinsing
6. Total cycle rime adjustable from 20s to 120s
7. Ingress protection code : IP61

Hodu	Dimensions(mm)	Electric Date
LS-2300	580x660x850	220~240V 50~60Hz 1Ph / 3.8kW

Ice cube machine

- Ice cubes are steadily supplied with microcomputer control
- Energy saving design
- Special jet injection design
- Vertical flow down method
- Water drain U-trap prevents foreign matter from entering machine
- Hygiene is optimized with antibacterial agent and corrosion resistant agents



Hodu	Dimensions(mm)	Electric Date
25LMV	398x450x800	220V 50~60Hz 1Ph / 120W



Cold drinking fountain

- Rugged steel construction
- Stainless steel skin top
- Coil on coil refrigerated cooling system
- Low maintenance
- Easy installation
- Environmentally friendly refrigerant R134a
- Compact, stylish, economical
- Optical internal filtration system
- Optional lever activated cup filler
- Optional push button cup filler
- Optional pump waste system where no immediate drainage is available

Hodu	Dimensions(mm)	Electric Date
ADF-632C	380x260x710	220V 50~60Hz 1Ph / 3.8kW

Glass crusher

- Disperator glass crusher makes light work of handling empty bottles, jars and glass containers by grinding them to small particles the size of sand
- Collection and transport of waste glass is time consuming because of large volume
- Model GKF550 is easy to install in a kitchen, galley or in a garbage room
- Alternatively, the glass crusher can be install on a lower level, near the point of waste collection and fed with empty bottles by a tube from the bar, kichen or galley above
- After being ground into small grains of glass with no sharp edges, an empty bottle has only 20% of its original volume means less storage space, less frequent collection and lower transport costs



Hodu	Dimensions(mm)	Electric Date
GKF550	365x1157x1325	220V 50~60Hz 1Ph / 1.25kW

Refrigerator(Domestic type)



- Reversible door type
- adjustable leveling legs
- Fully range temperature control
- Convenient plastic shelf
- Door stopper
- clean back design
- Lock & key device (left bottom part)
- Interior lighting
- PCM(Pre coated metal)
- PVC(Vinyl coated metal) available

Hodu	Dimensions(mm)	Electric Date	Capacity(Ltr)
FR-064R	440x452x511	220V 60Hz 1Ph / 0.1kW	59

Refrigerator(Domestic type)

- Right-hinged or left-hinged door can be available
- Adjustable leveling legs
- Fully range temperature control
- Convenient plastic shelf
- Door stopper
- Clean back design
- Lock & key device (left bottom part)
- Interior lighting
- PCM(Pre coated metal)
- PVC(Vinyl coated metal) available



Hodu	Dimensions(mm)	Electric Date	Capacity(Ltr)
HPRA26JW	480x531x858	220V 60Hz 1Ph / 0.1kW	140



Refrigerator(Domestic type)

- Right-hinged
- Adjustable leveling legs
- Fully automatic defrosting and restarting
- Door stopper
- Clean back design
- Lock & key device
- Interior lighting

Hodu	Dimensions(mm)	Electric Date	Capacity(Ltr)
FR-291	545x584x1620	220V 60Hz 1Ph / 0.1kW	268

Electric Convection oven

- Stainless still construction
- Glazed door allows good visibility to all part of the oven
- Due to a rounded corner inside of the oven, cleaning is easy



Hodu	Dimensions(mm)	Electric Date
HDO-3500	600x570x690	220V 60Hz 1Ph / 3.5kW

Laundry Equipment



Low spin washing machine



- Frontal, top and side panels in stainless steel ANSI 304
- Drum and outer drum in stainless steel INOX ANSI 304
- Ground fixing by means of four chemical bolts supplied with the machine
- Balanced water load : the washer is equipped with one cold inlet valve. When the program is started, the washing machine load cold alternate to hot water to reach the set washing temperature in the most quicker and precise way, time of heating and consequently the program length is reduced
- IM9 electric timer : six fixed programs which can be selected just pressing the corresponding key
- A led on the keypad signals the run program
- While the program is running three led are indicating which detergent is used
- The quick advance key allows to move inside the running cycle or to jump a complete program cycle bringing the machine in stand-by
- The "Cool down" key allows to insert a cooling before the drain step
- The spin cycle can be excluded just pressing the "NO SPIN" Key before the program start

Hodu	Dimensions(mm)	Electric Date	Capacity(kg)
RC 8	720x850x1034	230V 50Hz 1Ph	8
RC 11	720x955x1034	400V 50Hz 3Ph	11
RC 14	880x931x1314	400V 50Hz 3Ph	14

Electric tumbler dryer

- Eposidic painted panel
- Drum in stainless steel ANSI 304
- Ease of loading and unloading thanks to the large door opening angle(180°) and the big load diameter
- On request loft opening
- Easy access to the lint screen;
- Lint screen request displayed;
- A safety device stops the dryer if the door is opened while the dryer is working;
- IM7 Microprocessor : thanks to the use of icons and to the possibility to dialog in more languages, the user can easily manage the drying temperature and time. The 30 available programs can be easily modified and named
- Cooling cycle at the end of the program to avoid linen shocks;
- Easy maintenance thanks to the self diagnostic function with the following error displaying. The HELP area is reserved to the technician who can find there the trouble shooting of the most common error. The main devices correct working can be tested directly from the keypad.
- Management cost control: the total and partial consumption may be displayed.
- Reversing drum function to assure a uniform drying of the biggest linen (option)
- Power Control: the dryer can work on more power level (optional).
- Drum Speed Control: the drum speed can be controlled by the user from the key pad (option - only if the reversing drum option is present)
- Fan Speed Control: the suction fan speed can be controlled by the user from the key pad (option - only if the reversing drum option is present)



Hodu	Dimensions(mm)	Electric Date	Capacity(kg)
ES 10	791x707x1610	400V 50Hz 3Ph	10
ES 23	1022x918x1852	400V 50Hz 3Ph	23

High spin washing machine



- Frontal, top and side panels in stainless steel ANSI 304
- Drum and outer drum in stainless steel INOX ANSI 304 (5 years warranty)
- No need of ground fixing. To install the washing machine it is enough to adjust the rubber feet
- Innovative system PBS assuring the perfect drum balance even with partial or complex loads
- Ergonomics door locking system which reduces the user intervention : the door closing is controlled by the computer
- The modern IM* computer is equipped with a touch screen and is able to store up to 200 programs, in the standard version, a lot more if the memory is expanded
- Double program level standard on all washing machine
 1. The easy PROG interface allows the user to create his own program just answering to few simple questions
 2. The EXPERT PROG interface allows the specialized technician to create customize programs based on the laundry need

Hodu	Dimensions(mm)	Electric Date	Capacity(kg)
LM 8	720x853x1039	400V 50Hz 3Ph	8
LM 11	720x958x1039	400V 50Hz 3Ph	11
LM 14	880x934x1344	400V 50Hz 3Ph	14

Flatwork ironers

- New microprocessor friendly use
- New display showing information about the ironer work (temperature and ironing speed) and about the running function
- Chest pressure uniform for all the roller length : better ironing quality
- Chest pressure do stay always the same, even if the roller flattens
- Chest pressure modifiable according to the tissue to iron
- Possibility to save ironing programs different per temperature, speed and chest pressure
- More attention to the operator safe: one emergency stop, a hand safe bar and an additional safe bar, which lift the chest when it is press with the knee
- Adjustable introduction table
- Inverter standard on all models

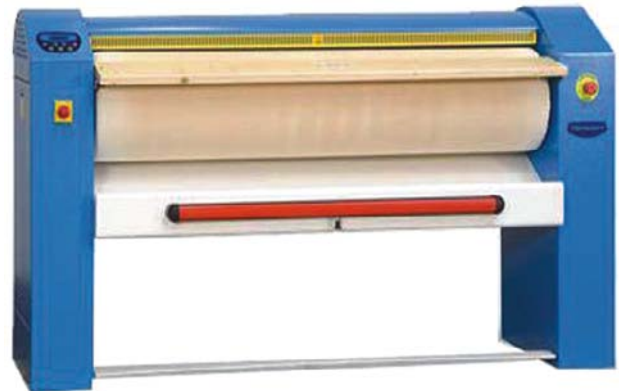

Hodu	Hourly Production(Kg/h)	Ruller	Roller Length
F11000/25	15/25	250mm	1000mm
F11250/25	20/30	250mm	1250mm
F11500/25	25/35	250mm	1500mm
F11500/33	30/40	330mm	1500mm
F11750/33	40/50	330mm	1750mm
F12000/33	50/60	330mm	2000mm

Catering Furniture



Established in 2001, **HODU INDUSTRIAL CO.** are the specialist catering system suppliers to the shipbuilding. With contacts from all over the world, you can be assured of the very best products and technology available when you choose **HODU INDUSTRIAL CO.** as your supplier



1-Bowl sink with dresser



Dresser with drawer

- Stainless steel furniture
- Top quality that complies with the strictest sanitation regulations.



Trolley



Chopping table

Galley Hood & Fire Extinguish System





- Tested according to ISO 15371: 2000
- Comply with SOLAS and approved by major classification societies (IACS)
- MED (Marine Equipment Directive) approval
- Provide protection for up to three deep fat fryers
- Automatic operation with detection(OPTION)
- Can be serviced on board by crew
- No electrical power required for operation

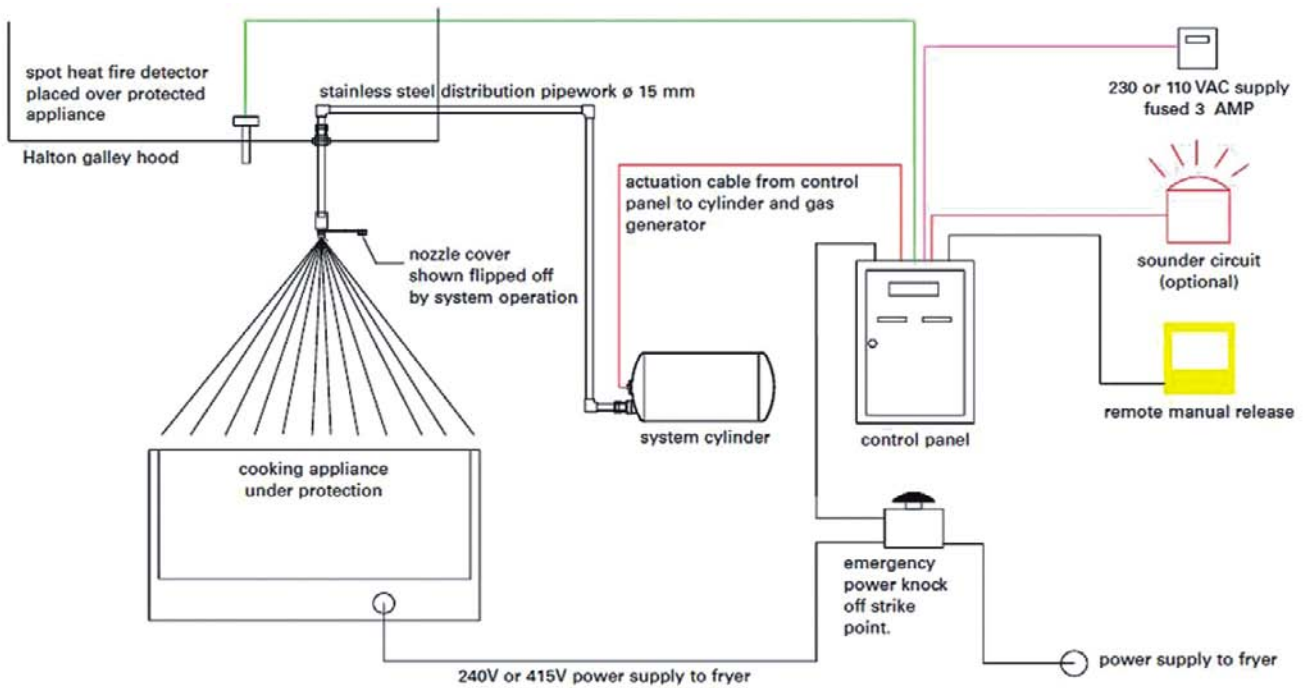

Medical Equipment





Hospitalization Bed



*Emergency Trolley
(Folding Type)*



*Stretcher
(Electric Type)*



Examination Couch



Sterilizer



First Aid Kit



*Portable Oxygen
& Accessories*



Doctor working chair



Medical locker



Instrument Trolley



Examination Lamp

Medical O₂ System

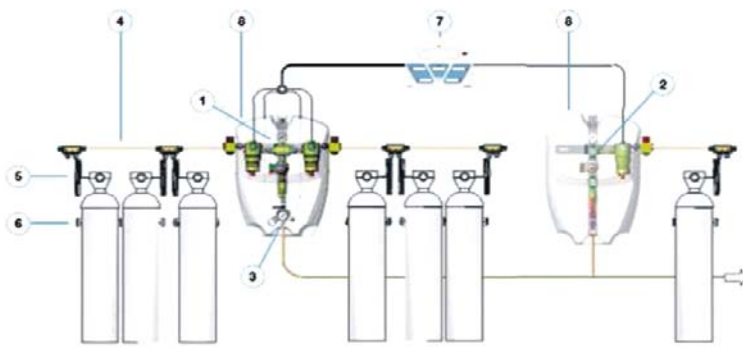

The **HODU IND**. High Pressure Supply System, has been specially designed for the distribution of medical gases. It ensures continuous gas distribution in complete safety by means of a fully automated change-over system, supply manifolds and alarm system.



1. Reducer-Changeover

- 2 filtering purge valves,
- sub-assembly 2 HP reducers with built-in safety valves,
- 1 automatic changeover,
- 1 MP reducer,
- 1 non-return valve,
- with all components assembled on a frame ready for connection.



2. Beck-up sub-Assembly

- 1 filtering purge valve,
- 1 HP reducer with incorporated vent valve,
- 1 pressure gauge,
- 1 MP reducer,
- 1 non-return valve,
- 1 shut-off valve,
- with all components assembled on a frame ready for connection.



3. VSP

(emergency and maintenance supply)

- 1 shut-off valve,
- 1 gas-specific connection,
- 1 0-16 bar pressure-gauge,
- 2 (1/4" G-CYL) sensor connection points,
- all components assembled and ready for connection.
- Install 1 Sensors connection assembly at the Reducer-Changeover exit if the VSP is installed elsewhere on the network.



4. Manifold sub-assembly

- HP Valve bos: 1 box for 1 or 2 cylinders.
- Bundle station: 1 support for 1 or 2 cylinders.
- 5 x 10 HP copper tube.



5. Pigtails/Ball-socket connections

- Pigtailed connections sold in pairs one right and one left

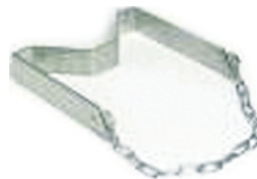

6. Cylinder rack

- Rack: 1 per cylinder.



7. Monitoring and alarm

- VIGI : 1 main unit and 1 mirror unit.



8. Protection cover

- 2 protection covers : 1 for the Reducer-Changeover sub-assembly and 1 for the Back-up sub-assembly

Sauna Unit



Sauna Unit

An electric sauna heating unit provided with electric heating elements arranged in a casing through which sauna room air flows to be heated has a temperature regulator including a transmitter, such as a thermostat bulb or thermostat, for sensing the temperature in the sauna room and a thermostat responsive thereto for connecting or disconnecting the heating elements in accordance with signals from the transmitter. The transmitter is mounted remotely from the heated air flow from the unit on an imperforate sidewall (preferably, the backwall) of the casing in spaced relationship thereto so as to be exposed only to the air flow in the sauna room and is located substantially horizontally and symmetrically relative to the center line of the unit and within the upper third of the height of the unit at a distance of 10-20 cm from the upper edge thereof. The transmitter is enclosed in a protective cover provided with air flow passages. The inner surface of the casing sidewall immediately adjacent the transmitter is designed to reflect heat radiation from the heating elements back toward the elements in order to reduce the effect of such heat radiation on the transmitter.



Sauna Accessory



Stone



Sauna Warning Sign



Sauna Lamp



Thermo-Hydro Meter

Entertainment Equipment



Established in 2001, **HODU INDUSTRIAL CO.** are the specialist entertainment equipments suppliers to the shipbuilding. With contacts from all over the world, you can be assured of the very best products and technology available when you choose **HODU INDUSTRIAL CO.** as your supplier



World Wide Multi System LCD TV (32")

- JVC, LT-series
- HD Compatibility (1080i 50/60Hz, 720p 50/60Hz)
- W-XGA (1366 x 768 pixels)
- HDMI Input
- Integrated D.I.S.T. (Digital Image Scaling Technology) System
- 1-tuner PAP (Picutre-and-Picture)
- 12 Multi Picutre
- Picture & Text Dual Screen
- Front 2 Oblique Cone Speakers
- Cinema Turbo (Cinema Surround)
- AHB (Active Hyper Bass)
- Tone Correction
- Computer Controlled Fastext
- Size : W800*H591*D244 (table top stand)
- Weight : 17.4kg (table top stand)
- Power : AC110~240V, 50/60Hz
- Power consumption : 127W
- Multi-System (PAL, SECAM, NTSC4.43 & NTSC3.58)



Portable Cassette Player

- PLL SYNTHESIZED DIGITAL TUNING
- PROFESSIONAL DIGITAL MULTI-BAND WORLD RECEIVER
- BACKLIT LCD DISPLAY
- AM/FM STEREO/SW/LW
- FIVE TUNING METHODS
- 54 PRESETS
- AUTO TUNING SYSTEM(ATS)
- SSB(SW BAND ONLY)
- DUAL CONVERSION
- FINE TUNING CONTROL
- MEMORY SCAN
- TONE CONTROL
- STEREO HEADPHONES
- REAL & DUAL TIME
- 2 ALARM TIMERS
- ADJUSTABLE SLEEP TIMER
- POWER SOURCE : AC220V,60Hz,1PH
- Dimensions (W/H/D) : 214 x 128 x 28.5 mm
- Weight : 583g



Color Television(Flat CRT,29")

- JVC, AV-29 series
- Worldwide multi system-NTSC, PAL, SECAM
- Power source : AC 220V, 60Hz
- Output : audio / video (RCA) x 1
- Weight : 42.5 kgs
- Accessory : multi function remote controller with battery
- Power consumption : 167W
- Dimension : W 812 * D518* H 584



CD/Cassette Player

- Power output: 2000w P.M.P.O (180w RMS)
- DVD Video/DVD-R/-RW/+R/+RW/CD/MP3/CD-R/-RW/JPEG
- WMA/MP3/JPEG on DVD
- Radio Tuner, Double Cassette Deck
- Dobby Digital / DTS (2ch) Built-in
- Dragonpick and Rocket Start Technology
- Sound Turbo Karaoke
- Dimensi (W/H/D) : 695 x 337 x 370 mm
- Power : 220VAC, 50/60Hz



World Wide Multi System LCD TV(42")

- Brightness(cd/m²)
- Resolution 1680 x 1050p
- Dynamic Contrast 3,000:1
- Response Time 5ms
- Audio Output 3W + 3W
- Aspect Ratio 16:9
- HDMI Input
- PC Input
- SIZE : W558*H453*D216 (W / TABLETOP STAND)
- WEIGHT : 7.3kg (W / TABLETOP STAND)
- POWER : AC110~240V, 50/60Hz
- POWER CONSUMPTION : 65W
- World Wide Multi-System(PAL, SECAM, NTSC)
- WITH REMOTE CONTROLLER & WALL BRACKET



DVD VCR Combo

- DVD Player + 6 Head Hi-Fi VCR
- -Slim Design (78.5mm)
- -Multi-Format Playback
- -DVD-Video/DVD±R/DVD±RW/SVCD/VCD/VHS
- -Audio CD/CD-R/CD-RW/MP3 CD/WMA
- -JPEG
- -DivX Playback
- -PAL Progressive Scan
- -MP3 with JPEG Slide Show
- -Coaxial/Audio Output
- -S-Video Output
- -Component Video(Y, Pb, Pr) Output
- -Auto Play
- -One Minute Fast Rewind (VCR)
- -x2 Soft Scan

Cinema System for Marine & Offshore





Beam Projector

- XGA(1024X768)
- 5000 lumens
- Contrast ratio : 2800:1
- Screen size : 40"~200"
- AC100~240V, 50/60Hz
- 350w

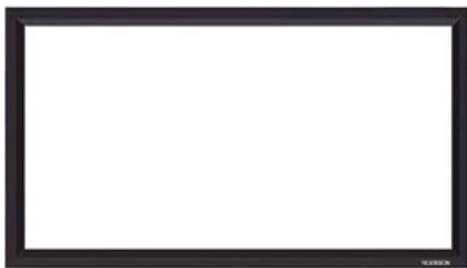

Screen (Manual & Electric)

- Size : 150"



Blu-Ray DVD Player

- Blu-ray player
- 1080p full HD output
- HDMI / component video / digital coaxial output
- USB port
- PAL & NTSC
- Progressive scan
- Multi format playback



Mixer

- 16-channel ultra-low noise compact mixer with highest possible headroom
- 16 studio-grade XDR2™ Extended Dynamic Range mic. preamps
- 16 High-headroom line inputs, 16 channel inserts
- Advanced DC pulse transformer RF rejection
- 60mm long-wearing logarithmic-taper faders
- 4 Aux sends, level, pan, -20dB/Solo and Overload/Mute_LEDs on each channel
- 4 stereo Aux returns, 8 Direct outs, 4 Group/Bus outputs
- 3-band Active EQ with sweepable midrange
- New Multi-Voltage power supply for worldwide use



Amplifier

- Sensitivity : 0,7V - 1V - 1,4V (selection through switch)
- Input impedance : 20kOhm (Balanced) / 10kOhm (Unbalanced)
- Output : Continuous burst tone 20 ms (0dB) / 480ms (-20dB) in accordance with EIA RS-490 and IEC 60268-3 (IHF A-202)
- Both channels : 1300 W / 700 W(4 & 8 ohm)
- Bridged 8 ohm : 2600 W
- Mains : AC 230 V, 50/60 Hz
- Frequency response : 20 Hz - 20 kHz (+/-1 dB)



Speaker

- BAL line input : 1.5v, 10k ohm
- Mains : 230v +/- 10%
- Consumption at maximum power : 2A
- LF-MF : 1x10" neodymium driver
- HF : 1" neodymium driver
- Frequency response : 50 hz~19khz



Mic. & Stand

- Frequency response tailored for vocals, with brightened midrange and bass roll off to control proximity effect
- Uniform supercardioid pattern for high gain before feedback and superior rejection of off-axis sound
- Neodymium magnet for high signal-to-noise output
- Hardened steel mesh grille that resists wear and abuse
- Advanced pneumatic shock mount system that minimizes transmission of mechanical noise and vibration
- Minimally effected by varying load impedance

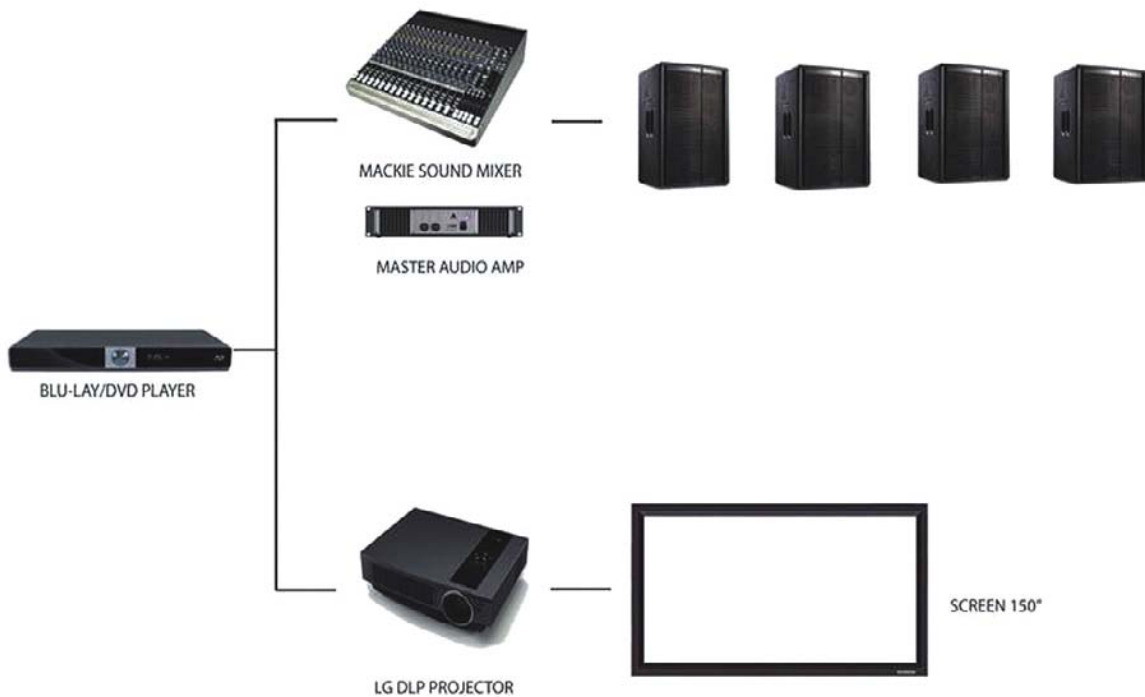

Gymnasium Equipment



Established in 2001, **HODU INDUSTRIAL CO.** are the specialist gymnasium equipments suppliers to the shipbuilding. With contacts from all over the world, you can be assured of the very best products and technology available when you choose **HODU INDUSTRIAL CO.** as your supplier

Multi-Station

User Capacity : 8



User Capacity : 3



User Capacity : 3-upgradeable to 4



User Capacity : 1



Weight Set

Bench Press



Arm curl Bench



Multi adjustable bench



Weight Rack



Dumbbell Rack



Dumbbell



Cardio

Cycle Machines



Treadmills (Running Machines)



Stairclimber



Rowing Machine



Etc.

Ping pong Table Set



Wall Bar
- Material : Wood or steel



Mat (50T)



Mat (200T)



Punching Bag Set



Weight Scale



Football Table



Dart Board



Folding Partition



Established in 2001, **HODU INDUSTRIAL CO.** are the specialist wall partition equipments suppliers to the shipbuilding. With contacts from all over the world, you can be assured of the very best products and technology available when you choose **HODU INDUSTRIAL CO.** as your supplier.

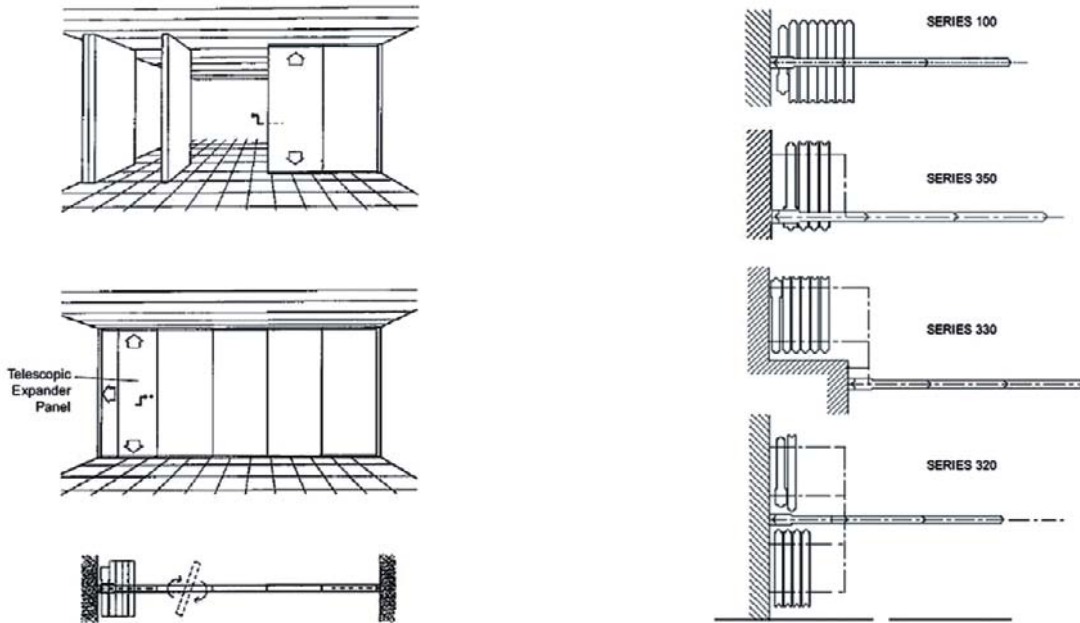

Typical series 100 In-Line track system and parking arrangement

Standard acoustic ratings available of 40,44,49,52, up to a maximum of 56dB.
Overall weight 34 - 56kgs per square metre.

Panel Stacking

Options Shows the various remote stacking examples available including standard series 100 (single point suspension) and series 610 which offers a full height pass door hinged from either jamb post without the need for a telescopic panel, Tracks can be extended to parking areas to be located remotely.



Switch & Receptacle Electric Device System



Established in 2001, **HODU INDUSTRIAL CO.** are the specialist switch & receptacle electric device system suppliers to the shipbuilding. With contacts from all over the world, you can be assured of the very best products and technology available when you choose **HODU INDUSTRIAL CO.** as your supplier

Eikon Type



Round cover plate with 3 modules button



Classic cover plate with 3 modules button



Infrared receiver



Methane gas detector



Interlocked socket



Digital keypad

Plana Type



Essential design switches cover plate and with 3 modules button



Protection socket for the safety



Buttons and devices in one, two or three modules with symbols



Multi function light control



Infrared receiver device

Idea Type



Plate with 3 modules button

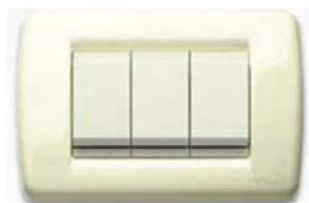

Cover plate with 3 modules button



Timer-thermostat



Cover plate with 2 modules button



Cover plate with 3 modules button

Curtain & Interior



Established in 2001, **HODU INDUSTRIAL CO.** are the specialist curtain equipments suppliers to the shipbuilding. With contacts from all over the world, you can be assured of the very best products and technology available when you choose **HODU INDUSTRIAL CO.** as your supplier

Door and Wall Protection System

Class A Fire Rating & IL

Design and Combine IPC Door and Wall products with Signscape signs and Clickeze fabrics in matching colors, helping you create a color coordinated environment.



Curtain Construction

All stitching will be performed with lock stitching machines. Edgings and hems are tacked assuring a top quality product that will provide outstanding durability for years. Patterned nylon mesh has integral webbing at the top and bottom to ensure long lasting durability. The mesh is to sewn to the body of the curtain using a double needle interlocked stitch, which ensures that the curtain will have a finished look that will be durable. All curtains are inspected for quality construction prior to being packaged in clear plastic bags to guarantee the customer receives a clean curtain at the time of delivery.

Lighting Fixture



Established in 2001, **HODU INDUSTRIAL CO.** are the specialist lighting equipments suppliers to the shipbuilding. With contacts from all over the world, you can be assured of the very best products and technology available when you choose **HODU INDUSTRIAL CO.** as your supplier



Fluorescent ceiling light(N,W,T Flush type)

- Ingress of Protection : IP20
- Lamp : 2 × 18/20W, 2 × 36/40W
- AC100~230V,50/60Hz
- Weight : 5.2kg, 11.5kg



Fluorescent ceiling light(W,T Surface type)

- Ingress of Protection : IP56
- Lamp : 2 × 18/20W, 2 × 36/40W
- AC100~230V,50/60Hz
- Weight : 7.2kg, 11.0kg

Fluorescent mirror light



- Ingress of Protection : IP44
- Lamp : 15/20W
- AC100~230V,50/60Hz
- Weight : 2.0kg



- Ingress of Protection : IP44
- Lamp : 15/20W
- AC100~230V,50/60Hz
- On/Off switch
- Weight : 2.0kg
- W/Shaver Socket



- Ingress of Protection : IP44
- Lamp : 15/20W
- AC100~230V,50/60Hz
- Weight : 2.5kg
- W/Shaver Socket

Single-bulb ceiling light



Double-bulb ceiling light



Single-bulb ceiling light



Round fluorescent ceiling light



Decorative light



Wall light



**Fluorescent desk light**

- Ingress of Protection : IP20
- Fluorescent : 27W
- AC100~240V,50/60Hz
- Weight : 4kg

**Fluorescent down light**

- Ingress of Protection : IP20/44
- Fluorescent : 18W
- AC100~240V,50/60Hz
- Weight : 1.5kg

**Speaker**

- Flush Type
- Material : Steel & P.C
- Painting Color : RAL 7032 / White N9.5 etc.
- Cable Gland : PG13.5
- Protection Fuse : 4A
- dB : 70dB
- IMP. : 8.0k (100Volt)
- Weight : 1.2kg

Glass wall & Door



Established in 2001, **HODU INDUSTRIAL CO.** are the specialist lighting equipments suppliers to the shipbuilding. With contacts from all over the world, you can be assured of the very best products and technology available when you choose **HODU INDUSTRIAL CO.** as your supplier

Glass Wall

Our glass walls are the leading product when you are looking for a fire rated glass walls made from aluminium. Thanks to the unique design and the patented filling material, that makes it possible to produce fire rating narrow frames that fulfill most standards of testing.

- Narrow line
- Different surface
- Aluminium - non corrosion
- Different glass thickness
- Individual hardware options

Surfaces

Our products can be powder coated in any RAL and NCS color or anodized in standard colors or the Silver surface.

Union - Copenhagen



School - Copenhagen



Bank - Copenhagen



Glass walls are uniquely designed for its high durability and custom made to size and color.

Hotel - Copenhagen



Glass walls are tested and approved from EI30-EI60 according to EC standards. This means that can deliver full glazed glass wall for inside and outside use. HODU IND. is certified according to the society and is now ready to fulfil the new European CEN Standard.

Snit A-A

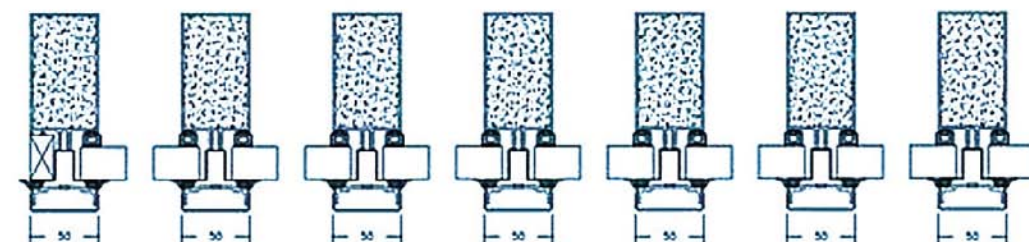

Snit F-F

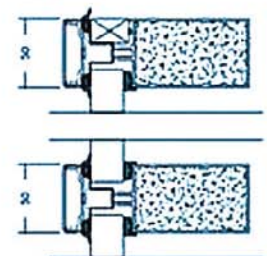

Doors

Doors are the leading product when you are looking for a fire rated glass doors made from aluminium. Thanks to the unique design and the patented filling material, it is possible to make narrow frames with fire rating that fulfill most standards of testing.

- Narrow line
- Different surface
- Aluminium - non corrosion
- Different glassthickness
- Individual hardware options

Surfaces

Our products can be powder coated in any RAL and NCS color or anodized in standard colors or the Silver surface.

Shopping center - Copenhagen



Aqualand



School - Copenhagen



Insurance - Copenhagen



Doors can be combined with fixed side partitions and over lights and equipped with automatic openers, panic bars, electric strikers etc.

- Doors strong details
- High quality
- Long lasting

Doors are uniquely designed for its high durability. Doors are custom made to size and color.

Doors specifications Doors made to meet the fire testing class.

E30	Syste AF50
E130	System AF55
E160	System AF85
E190	System AF105

As single and double doors.

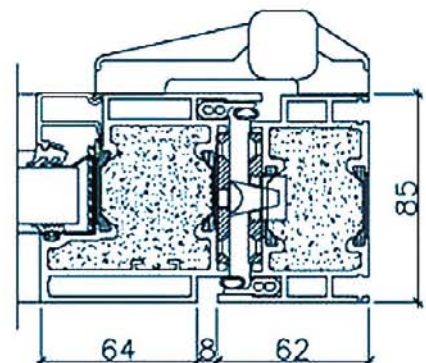
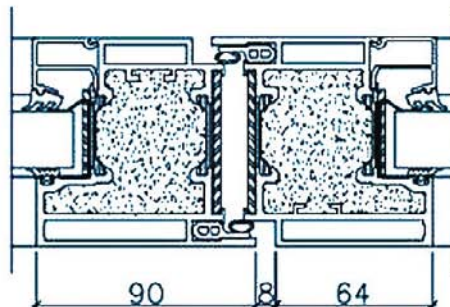
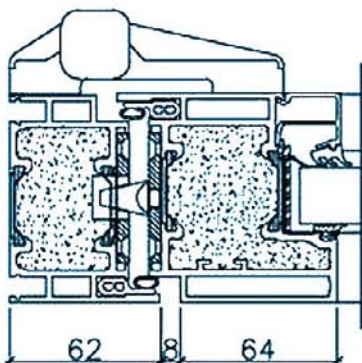

Marine Sector

HODU IND. is the leading company when you are looking for fire rated full glazed single door, double door, sliding door, window and glass wall.

Our products are tested in several countries and approved from B15 - A60 according to IMO regulation. Thanks to the unique design and the patented filling material, that makes it possible to produce fire rated narrow frame that fulfills most standard of test.

- Narrow line
- Different surface
- Aluminium - non corrosion
- Different glassthickness
- Individual hardware options



Norwegian Pearl - Norwegian Cruise Line



Radiance of the Sea Royal Caribbean Cruises

Surfaces

The products can be powder coated in any RAL or NCS color or anodized in standard colors or the silver surface.

The products can be assembled to each other and equipped with automatic door openers, panic bars, electrical strikers etc.

The production is certified by Bureau Veritas, and MED certificates are available on most applications. All certified products have Mark of Conformity and are tested with accredited fire institutes in Europe according to IMO 754.18 and USCG standards.



SKYCON MECHANICAL ACCESS AB

The logo for Skycon, featuring the word "SKYCON" in a bold, blue, sans-serif font with a yellow swoosh underneath.***Skycon Mechanical Access AB company presentation.***

Skycon AB has been delivered Window Washing Systems and Access Platforms to ships since 1987. We have delivered our systems to more than 100 major cruise vessels until today, this puts us as the main supplier in the world of this product.

We have delivered equipment to ships for all major cruise ship owner. Due to our high quality, flexibility and problem solving engineering we have still same ship owner requesting Skycon equipment today as for 22 years ago.

Our construction office is located in Jarfalla, just outside Stockholm. We are 6 persons working in this company. We are doing all design work from this office, our engineers are also involved in the newbuilding stage at the different yards as well as service on ships already in traffic.

The manufacturing of our products has been done in the same factory in Sweden for all years, therefore they are also very specialized in the production of Window Washing Systems and Access Platforms used in marine environment.





MML // A GLOBAL COMPANY

MML has a long history in the marine industry being founded in 1903 within Glasgow's City centre as a supplier of hardware to the Clyde shipyards. Since then we have anticipated market changes and adapted our skills to supply the market's needs and ensuring that we can fulfil our customer requirements. MML continues this trend by playing a key role in the offshore wind development in the UK and Europe.

Quality is key to MML with both facilities operating ISO 9000:2001. All MML products are MED or DNV certified where relevant, supplying each product with its certifications. As well as this MML has a stringent internal quality programme, ensuring all products meet MML's exacting standards and ensuring continuous improvement to all aspects of the company.

Types of marine & offshore doors

- A CLASS DOORS
- H60/ H120
- B15
- WATERTIGHT DOORS
- NAVY SUPPLY DOORS
- YACHT DOORS
- WINDOWS



THE MAP FOR HODU INDUSTRIAL CO.

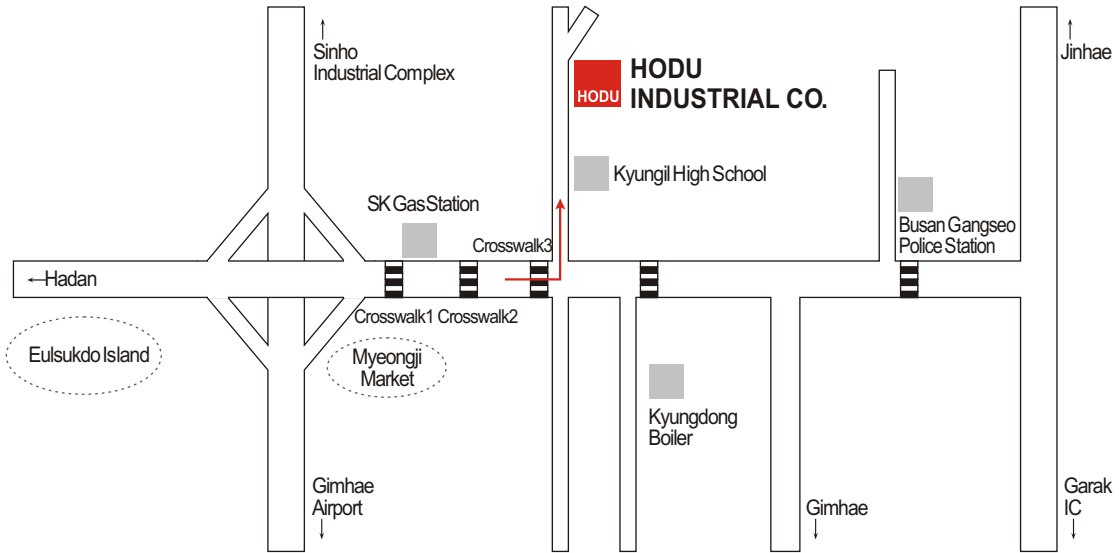

#1400-5, MYEONGJI-DONG, GANGSEO-GU, BUSAN, KOREA
 TEL : +82-51-291-9512, FAX : +82-51-291-9513
<http://www.hoducompany.com>, E-mail : sales@hoducompany.com

AGENT



UK
Door



JAPAN
Calmmoon sheet



UK
FIRE EXT. SYSTEM



DENMARK
Glass wall



SWEDEN
Window washing system



ITALY
Switch & Receptacle



USA
Curtain



CANADA
Explosion proof telephone



#1400-5, Myeongji-dong, Gangseo-gu, Busan, 618-815 Korea
Tel. 82 51 291 9512 Fax. 82 51 291 9513
E-mail. sales@hoducompany.com
www.hoducompany.com