

THIS IS NOT A
CERTIFIED COPY

RESOLUTION FILED
DATE: 4-6-06
OR BK 16312 PG 1618
BY *[Signature]*
DEPUTY CLERK

MAP OF THE TOWN OF GOLF PARK FLORIDA

A SUBDIVISION OF THE N.E. 1/4 OF SEC. 2, TOWN 28 SOUTH, RANGE 17 EAST
HILLSBORO COUNTY, FLORIDA

RESOLUTION FILED
DATE: 5-4-06
OR BK 16431 PG 1536
BY *[Signature]*
DEPUTY CLERK

RESOLUTION FILED
DATE: 9-29-05
OR BK 15500 PG 201
BY *[Signature]*
DEPUTY CLERK

RESOLUTION FILED
DATE: 4-6-06
OR BK 16312 PG 1611
BY *[Signature]*
DEPUTY CLERK

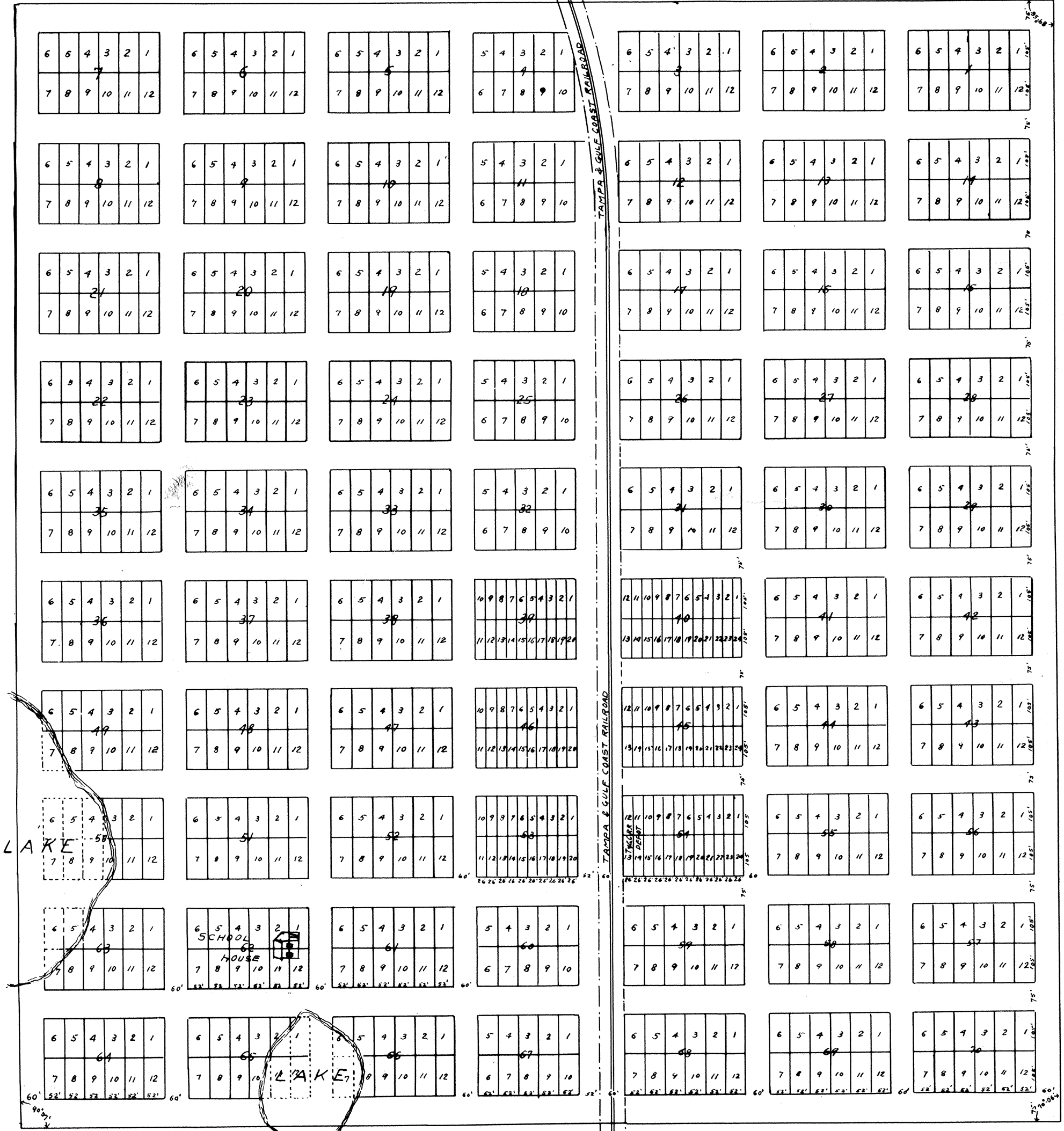

Filed Sept. 30, 1913
W. P. Culbreath, C. I. N.
By Frances M. Tlend, D. C.

STATE OF FLORIDA
COUNTY OF HILLSBOROUGH
THIS IS TO CERTIFY THAT THIS PLAT IS A
TRUE AND CORRECT COPY THAT HAS BEEN
PHOTOGRAPHICALLY RE-CREATED FROM THE
ORIGINAL PLAT OR TRACING THEREOF
RECORDED BY THE CLERK OF CIRCUIT COURT
OF HILLSBOROUGH COUNTY, FLORIDA

RECORD VERIFIED
WITNESS MY HAND AND OFFICIAL SEAL THIS
10 DAY OF July, 19 27
RICHARD AKE, CLERK
[Signature] DEPUTY CLERK

