

EXB-8205 & EXB-8505 8mm  
Tape Drives

---

# Illustrated Parts Catalog

## Copyright

Copyright 1993 by EXABYTE Corporation. All rights reserved. This item and the information contained herein are the property of EXABYTE Corporation. No part of this document may be reproduced, transmitted, transcribed, stored in a retrieval system, or translated into any language or computer language in any form or by any means, electronic, mechanical, magnetic, optical, chemical, manual, or otherwise, without the express written permission of EXABYTE Corporation, 1685 38th Street, Boulder, Colorado 80301.

## Disclaimer

EXABYTE Corporation makes no representation or warranties with respect to the contents of this document and specifically disclaims any implied warranties of merchantability or fitness for any particular purpose. Further, EXABYTE Corporation reserves the right to revise this publication without obligation to notify any person or organization of such revision or changes.

## Trademark Notices

EXABYTE is a registered trademark and EXATAPE is a trademark of EXABYTE Corporation.

## Revision History

Revision	Date
000	April 1993

EXABYTE Corporation  
1685 38th Street  
Boulder, Colorado 80301  
(303) 442-4333

510704-000

# Contents

1	Ordering Information . . . . .	1-1
2	FRU Illustrations, Names, and Part Numbers . . . . .	2-1

## Product Warranty Caution

The EXB-8205 and EXB-8505 8mm Cartridge Tape Subsystems (CTSs) are warranted to be free from defects in materials, parts, and workmanship and will conform to the current product specifications upon delivery. **For the specific details of your warranty, refer to your sales contract or contact the company from which the EXB-8205 or EXB-8505 was purchased.**

The warranty for the EXB-8205 and EXB-8505 shall not apply to failures caused by:

- Physical abuse or use not consistent with the operating instructions or product specifications provided by EXABYTE's personnel or agent for the applicable equipment.
- Modifications by other than EXABYTE's personnel or agent in any way other than those approved by EXABYTE, provided the warranty shall not be voided by the repair or replacement of parts or the attachment of items in the manner described in maintenance or installation instructions provided by EXABYTE.
- Repair by other than EXABYTE's personnel or agent in a manner contrary to the maintenance instructions provided by EXABYTE.
- Removal of the EXABYTE serial number tag.
- Physical abuse due to improper packaging of returns.

### CAUTION

Returning the EXB-8205 or EXB-8505 in unauthorized packaging may damage the unit and void the warranty.

If you are returning the EXB-8205 or EXB-8505 for repair, package it in its original packaging (or in replacement packaging obtained from your vendor).

If problems with the EXB-8205 or EXB-8505 occur, contact your maintenance organization; do not void the product warranty by allowing untrained or unauthorized personnel to attempt repairs.

# 1

# Ordering Information

Direct your purchase orders, inquiries regarding part orders, requests for quotations, order status, and any other parts support inquiries to EXABYTE Corporation's sales office. You can also contact Service Administration at the following address and number:

ATTN: Service Administration  
EXABYTE Corporation  
1685 38th Street  
Boulder, Colorado 80301

Phone: (303) 442-4333  
Fax: (303) 442-3816  
or  
(303) 447-7326

## Notes:

# 2

## FRU Illustrations, Names, and Part Numbers

Figure 2-1 on the next page illustrates the field replaceable units (FRUs) for the EXB-8205 and EXB-8505. Table 2-1 on page 2-3 contains the part numbers for these FRUs.

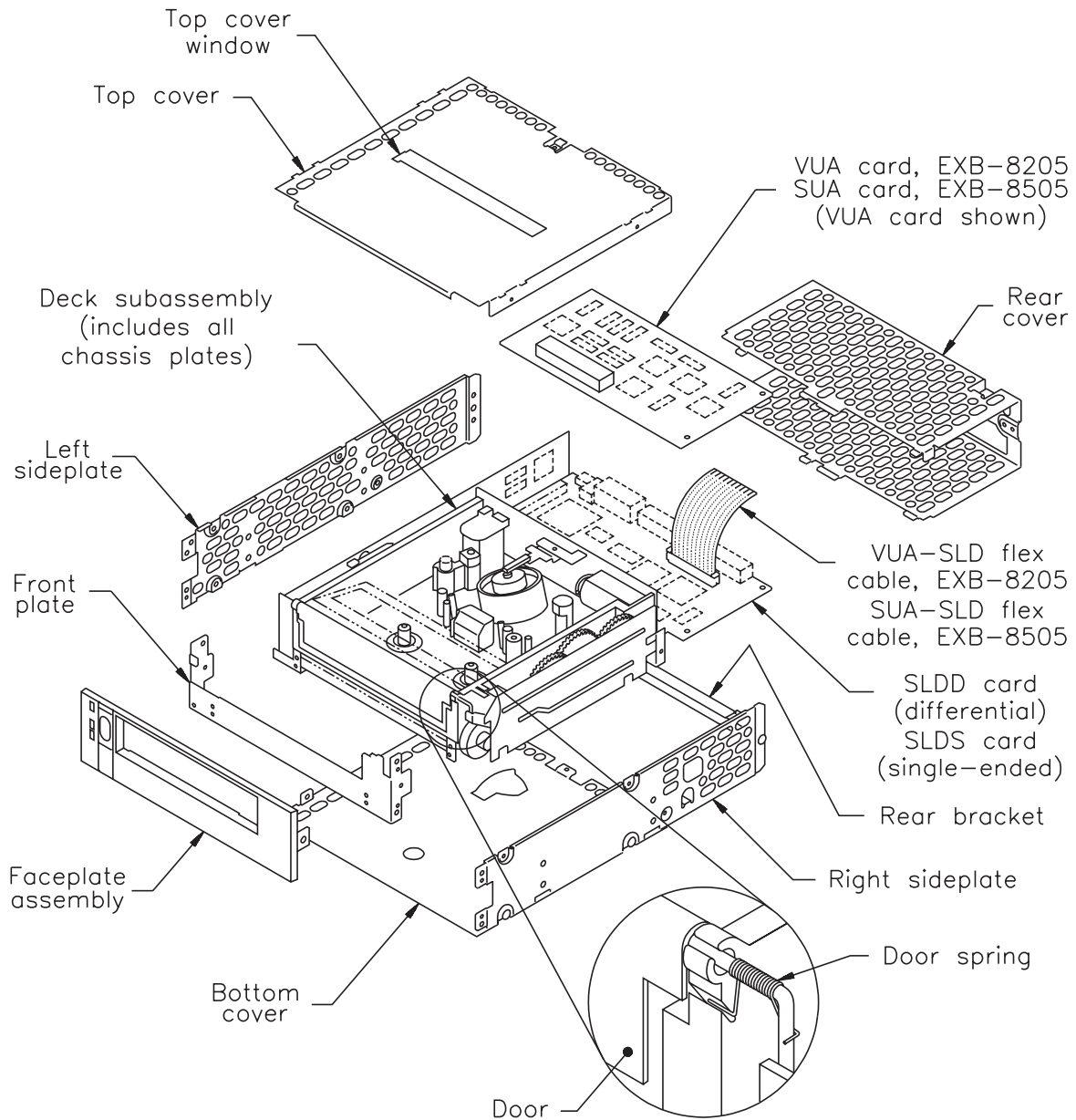

Figure 2-1 Field replaceable units for the EXB-8205 and EXB-8505



**Table 2-1** List of FRU names and part numbers

Part name		Part number
Chassis plates:	Front plate	110028
	Rear cover	110025
	Left sideplate	110027
	Right sideplate	110026
	Bottom cover	110024
	Rear bracket	110029
Deck subassembly <sup>a</sup> :	EXB-8205	F728065
	EXB-8505	F728075
Faceplate assembly: <sup>b</sup>	EXB-8205	F790025
	EXB-8505	F799025
Door with spring <sup>b</sup>		107025
SLDD card (differential)		F752006 <sup>c</sup>
SLDS card (single-ended)		F752004 <sup>c</sup>
VUA card (for the EXB-8205)		F784500
SUA card (for the EXB-8505)		F784100
VUA-SLD flex cable (or SUA-SLD flex cable)		006084
M2 × 0.04 × 3.0 screw (not shown)		140098
Window, top cover		000962

<sup>a</sup> The deck subassembly FRU includes the front, top, rear, bottom, left, and right chassis plates.

<sup>b</sup> The standard color for the door and faceplate is pearl white. For additional colors, contact your account representative for part numbers.

<sup>c</sup> Part numbers for the SLDD and SLDS card may vary according to customer needs.

## Notes: